

May 22, 2019

Curbed



Woolworth Building 'Pavilion' apartment with huge terrace wants \$33.5M

The terrace has some of the building's distinctive copper and terra cotta ornamentation

By Amy Plitt

Impressions: 1,280,000



Travis Mark

The Woolworth Building's crowning condos first hit the market all the way back in 2015, but it's only now that we're getting a peek inside some of the most interesting apartments in the building.

The developer, Alchemy Properties, recently listed an apartment on the skyscraper's 29th floor, dubbed the Pavilion Residences, for \$33.5 million. It's one of two units on that floor, which is where the building's setbacks begin, and what makes those apartments unusual is that they have outdoor space—both terraces and roof decks—created within those setbacks. The terra cotta and copper ornamentation that provides

May 22, 2019

Curbed

architectural interest on the building is especially prevalent in these units, which have Gothic spandrels and other decorative touches on their terraces.

The apartment that's currently on the market, Pavilion A, has five bedrooms and four bathrooms (plus two powder rooms), along with a huge great room and formal dining room. The terrace for that apartment is accessible from three of the bedrooms (including the expansive master suite); when you combine that and the roof deck, you're looking at more than 2,700 square feet of outdoor space.



The second apartment, Pavilion B, has not yet been listed; instead, it's been staged as a model unit, and is pictured in these images. It's the smaller of the two units,

May 22, 2019

Curbed

measuring around 4,600 square feet with an additional 1,250 square feet of outdoor space. It has three bedrooms, three bathrooms, and one powder room.

Also still hidden from public view is the building's Pinnacle, the five-story penthouse located at the tippy top of the skyscraper; that apartment is asking \$110 million, making it one of the most expensive homes for sale in NYC right now.

Pavilion A at the Woolworth Residences is listed with Stan Ponte of Sotheby's International Realty for \$33.5 million.



May 22, 2019
Curbed

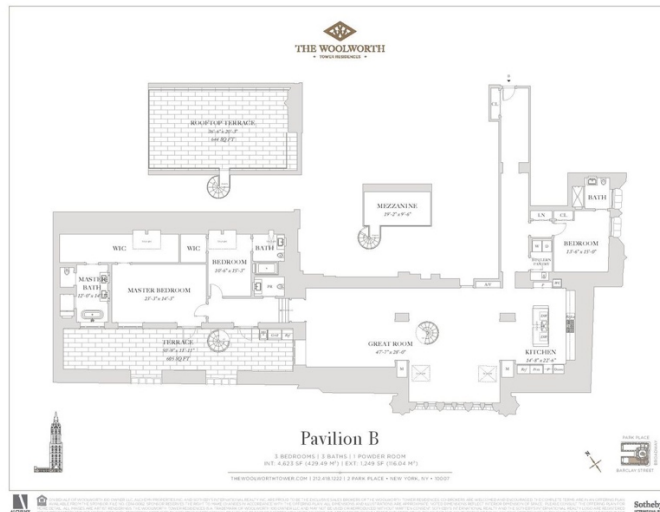
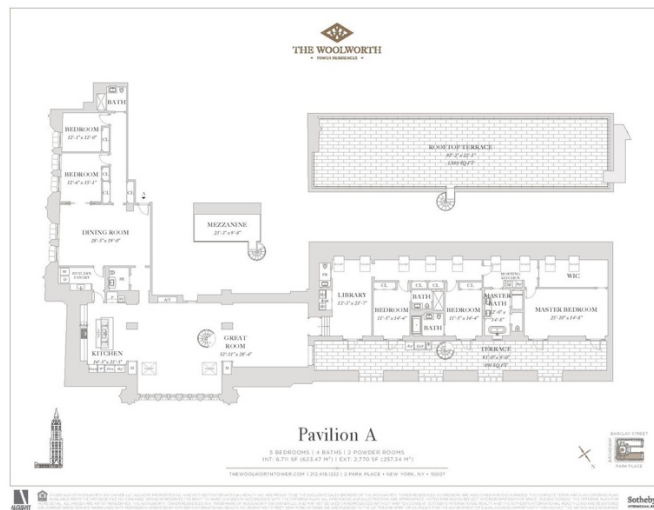

<https://ny.curbed.com/2019/5/22/18635714/financial-district-woolworth-building-condo-outdoor-space-for-sale>

May 22, 2019
Curbed