

March 14, 2017  
WallPaper.com

# Wallpaper\*

## New York's Latest Crop of Luxury Residential Developments

Author N/A

Impressions 250,000

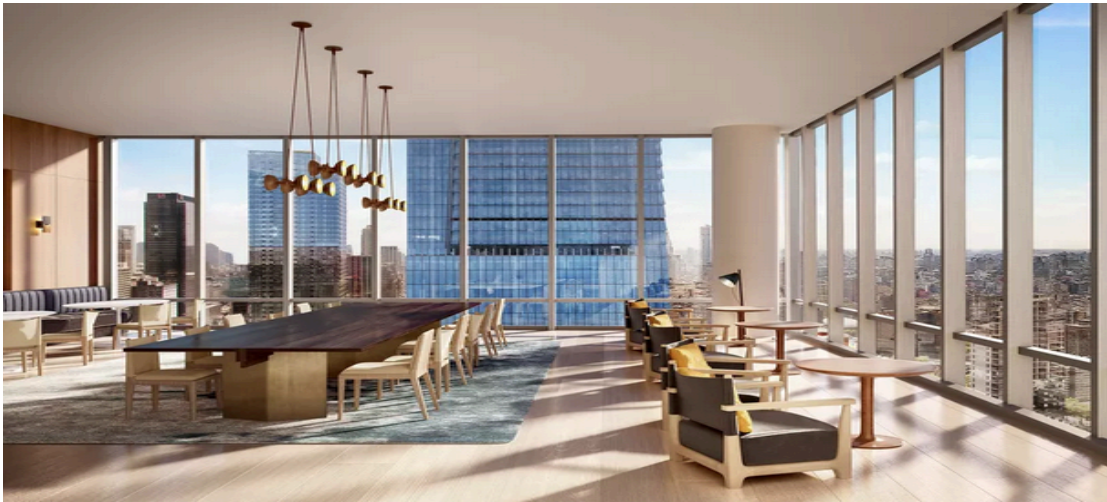

The Woolworth Tower Residences 28 March 2017

Once the world's tallest building when it was inaugurated by President Woodrow Wilson in April 1913, the Woolworth tower, originally commissioned by retail magnate F. W. Woolworth and designed by Cass Gilbert, will be ready for residential occupancy by the end of 2017. The upper floors – from levels 29 to 58 – of the Manhattan icon have been converted by Alchemy Properties into 33 condominium residences ranging from one bedroom to full-floor homes.

March 14, 2017  
WallPaper.com



The Woolworth Tower Residences 28 March 2017

The opening of these new residences at the Woolworth tower will mark the first opportunity for people to live inside the landmark. Two completed homes have now been revealed which have been fitted out by interior designers Alan Tanksley and Eve Robinson. With a private residential entrance at 2 Park Place, the building also features a pool, spa, fitness studio and the Gilbert Lounge on floor 29, exclusively for residents.

<http://www.wallpaper.com/gallery/architecture/new-yorks-latest-crop-of-luxury-residential-developments#193288>